

VICINITY MAP

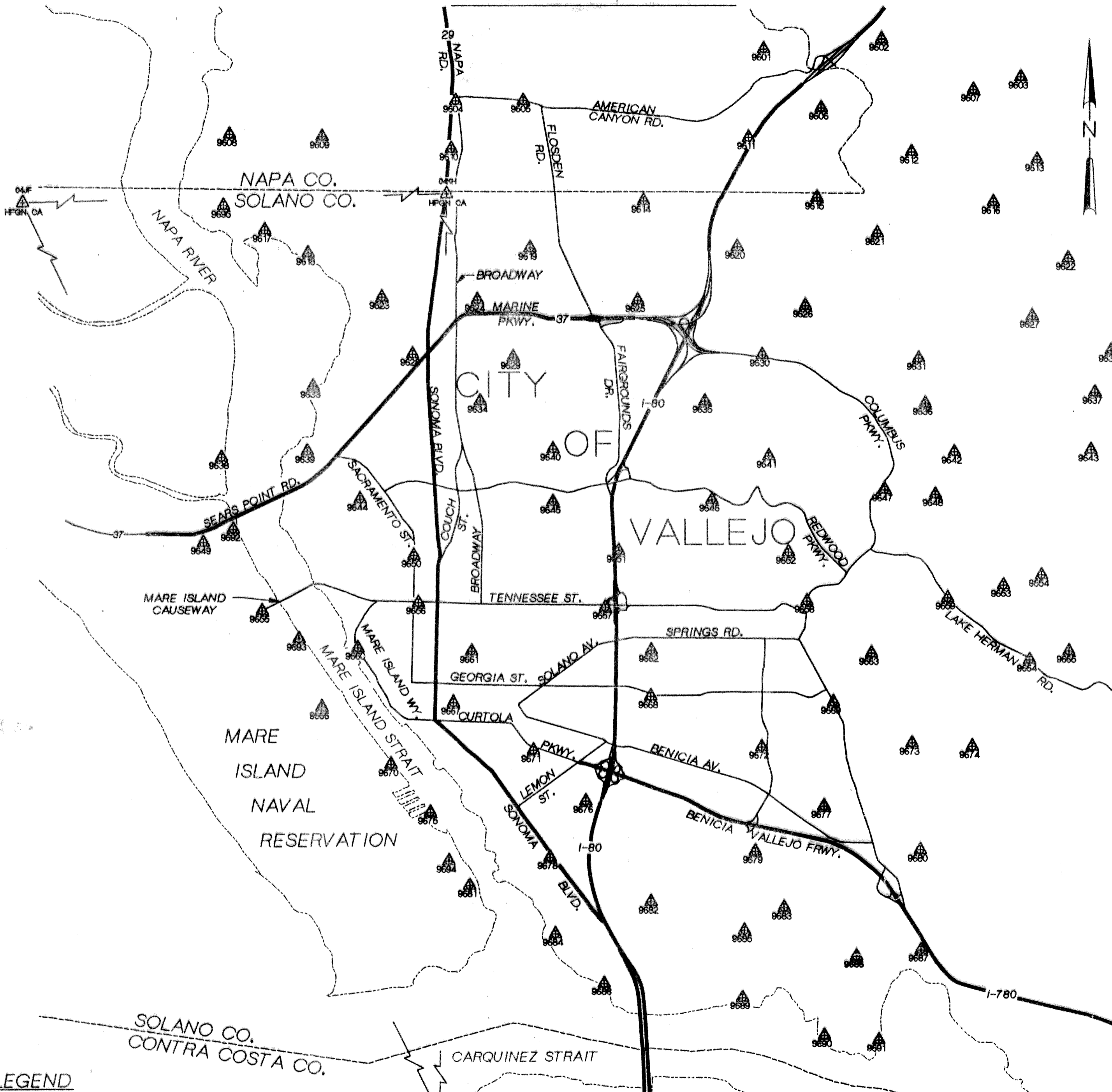

SURVEYOR'S STATEMENT
 THIS MAP CORRECTLY REPRESENTS A SURVEY MADE BY ME OR UNDER MY DIRECTION IN CONFORMANCE WITH THE REQUIREMENTS OF THE LAND SURVEYOR'S ACT AT THE REQUEST OF VALLEJO SANITATION AND FLOOD CONTROL DISTRICT IN FEBRUARY, 1997

(SIGNED AND SEALED) LARRY D. ADDISON
 L.S. NO. 5873
 LICENSE EXPIRATION DATE 12/31/2000

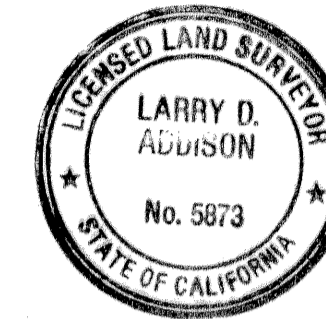

Larry D. Addison

COUNTY SURVEYOR'S STATEMENT

THIS MAP HAS BEEN EXAMINED IN ACCORDANCE WITH SECTION 8766 OF THE LAND SURVEYOR'S ACT THIS 25TH DAY OF March 1997.

John A. Gray
 JOHN A. GRAY R.C.E. 14860 EXP. 03-31-97
 COUNTY SURVEYOR

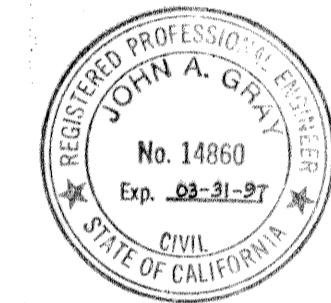

RECORDER'S STATEMENT

FILED THIS 26th DAY OF March, 1997
 AT 10:25 AM. IN BOOK 22 OF SURVEYS
 MAPS AT PAGE 83, AT THE
 REQUEST OF LARRY D. ADDISON

(SIGNED) *Robert Blechschmidt*
 ROBERT BLECHSCHMIDT, COUNTY ASSESSOR/RECORDER

97-18106 *By: S. Woodford, Deputy*
Record of Survey

GPS Geodetic Control Survey
 for
 Vallejo Sanitation and Flood Control
 District
 and
 The City of Vallejo

Located in

Sections 25, 26, 27, 34, 35 & 36, T. 4 N., R. 4 W.; Sections 26, 27, 28, 29, 30, 31, 32, 33, 34, & 35, T. 4 N., R. 3 W.; Sections 1, 2, 10, 11, 12, 13, 14, 15, and Mare Island Naval Reservation, T. 3 N., R. 4 W.; Sections 2, 3, 4, 5, 6, 7, 8, 9, 10, 11, 14, 15, 16, 17, 18, 19, 20, 21, 22, 27, 28, 29, 30, 31, 32, & 33, T. 3 N., R. 3 W., Mount Diablo Meridian, Napa and Solano Counties, California.

LEGEND
 GPS STATION THIS SURVEY
 CALIFORNIA HIGH PRECISION GEODETIC NETWORK STATION



CIVIL ENGINEERS & LAND SURVEYORS
 2525 AIRPARK DRIVE, REDDING, CALIFORNIA.

DATE: FEBRUARY 1997 SCALE: 1" = 3000'
 JOB No. : 137379.VS.CS
 SHEET 1 OF 3